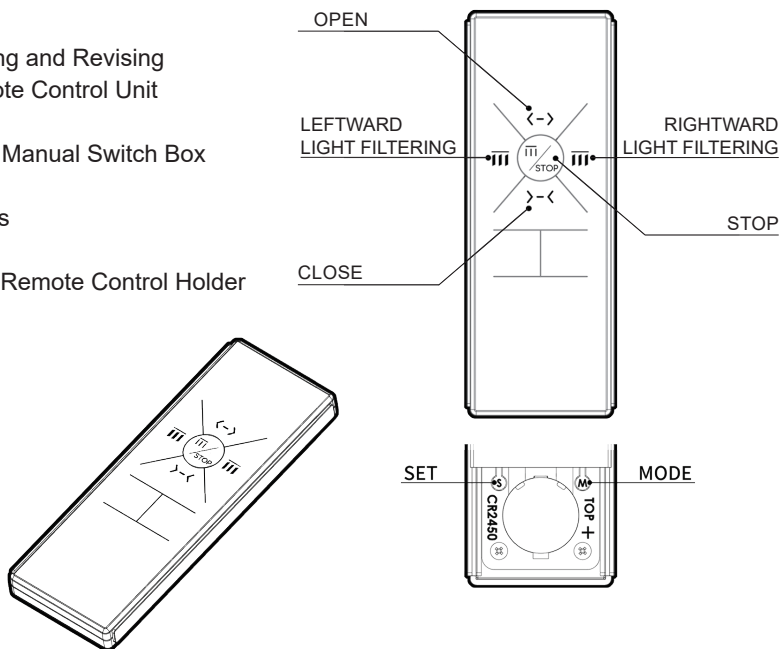



Table of Contents

- 1-1 Travel Distance Setting and Revising
- 2-1 Adding another Remote Control Unit
- 3-1 Clear Off Password
- 4-1 Externally connected Manual Switch Box
- 5-1 Battery Replacement
- 5-2 Product Specifications
- 5-3 Quick Setting Index
- 5-4 Instructions for using Remote Control Holder



How to open Battery Compartment Cover

△ Push the cover out

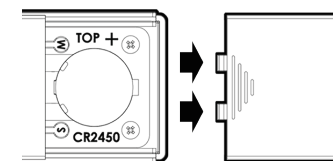

- STOP (1) When the curtain is moving, press [STOP] to stop the curtain.
(2) When the curtain is not moving, press [STOP] to flip the slats to the center position.

How to replace Battery Compartment Cover

- 1 Insert latches into corresponding slots
- 2 Place Battery Compartment Cover to engage it with Slides
- 3 Push the cover in

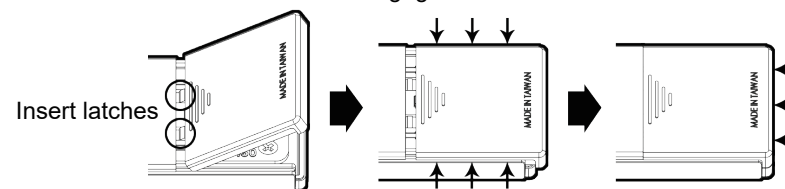

Key check-points prior to making settings

- 1 Make sure the slats of Vertical Blinds are installed properly before setting.
- 2 If six beep sounds occur during the setting, it means that the setting is not completed yet; it might be because there is power failure during the setting or [STOP] is accidentally pressed. Please go back to step 1-1 to reset.

1-1 Travel Distance Setting and Revising

- STEP-1** Press [OPEN] + [SET] keys until a short beep sound occurs.

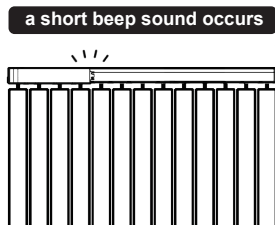
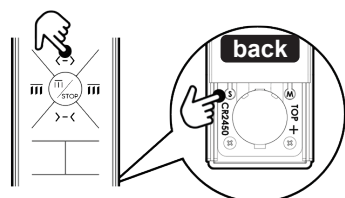

the curtain begins to set the travel distance automatically

steps:

- the curtain closes completely
- the slats are turned leftward and rightward
- the curtain opens completely
- the curtain closes and opens completely again

A long beep sound will occur, indicating that the travel distance setting is completed.

a long beep sound occurs

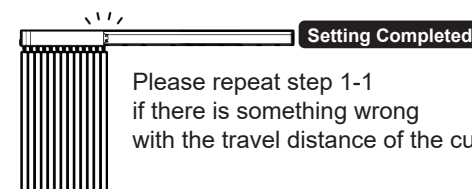

Please repeat step 1-1 if there is something wrong with the travel distance of the curtain.



2-1 Adding another Remote Control Unit

STEP-1 Press and hold [SET] until three short beep sounds occur, indicating that the setting mode of Adding another Remote Control Unit is activated.

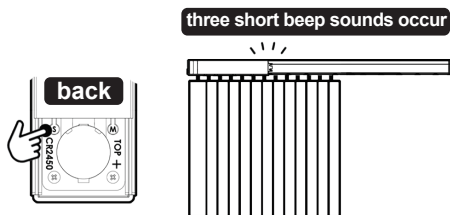

STEP-2 Now press [STOP] key of the Remote Control to be added; the adding process is completed when a short beep sound occurs.

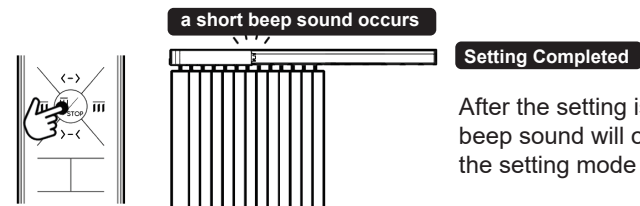

After the setting is completed, a long beep sound will occur, indicating that the setting mode is deactivated.

3-1 Clear off Password

STEP-1 Unplug power supply of the Motor, wait for 15 seconds, resume power supply of it. Within 8 seconds, press [OPEN] + [STOP] + [CLOSE] + any of blank keys [LEFTWARD LIGHT FILTERING] OR [RIGHTWARD LIGHT FILTERING] altogether 4 keys, beep sounds will occur immediately, then, within 5 seconds, press and hold [OPEN] + [CLOSE]. The beep sounds will then stop, indicating that the password is cleared off.

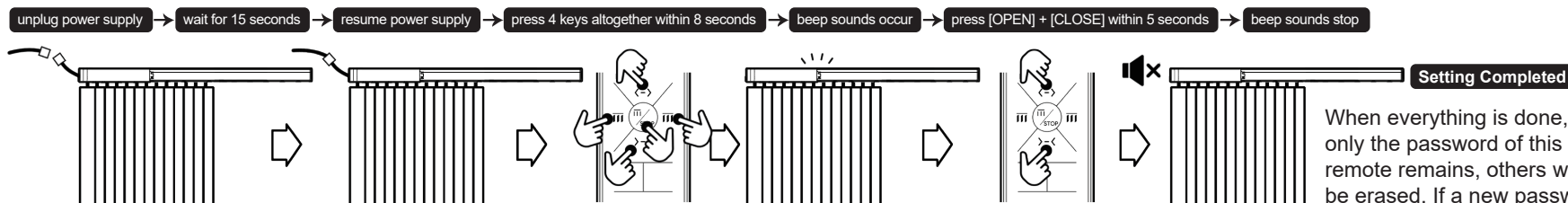

When everything is done, only the password of this remote remains, others will be erased. If a new password is not added, the old password will not be erased.



4-1 Externally connected Manual Switch Box

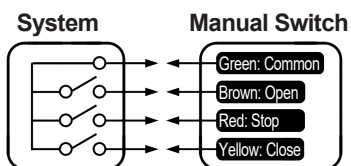
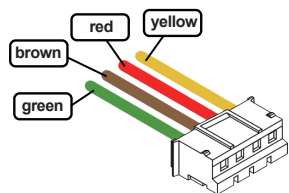

A brief contact will activate the function;
DO NOT short-circuit continuously.

Instructions

Green + Brown = open the curtain

Green + Yellow = close the curtain

Green + Red = if the curtain is moving, it will stop immediately.
= if the curtain is not moving, the slats will be turned.

REMINDER The slats cannot be turned if the current position of the curtain is at 1/4 of the total travel distance.

Green + Brown + Red = the curtain turns left; the slats open.

Green + Yellow + Red = the curtain turns right; the slats close.

5-1 Battery Replacement

- With flat side (positive +) of the Battery facing upwards, making sure that the Battery is latched up by two spring plates, insert Battery in a slanted angle to enter it into the Battery Holder.

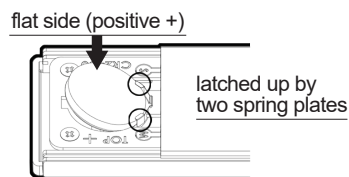

- Completed.

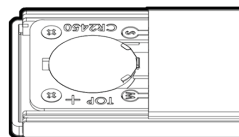

5-2 Product Specifications

Battery: CR2450 3V (One-time type lithium battery)

Dimensions: L 13CM, W 4.8CM, H 1.1CM

Standby Current: <1uA

Modulation Method: OOK

Encoding Method: Internally-burnt fixed coding

Transmission Frequency: 433.92MHz

Antenna Type: on board, Gain=0 dbi

Weight (including battery): 66g



5-3 Quick Setting Index

Travel Distance Setting and Revising:

- (1) Press [SET] + [OPEN] keys, the curtain begins to set the travel distance automatically.
- (2) A long beep sound will occur, indicating that the travel distance setting is completed.

Adding another Remote Control Unit:

- (1) Press [SET], three short beep sounds will occur.
- (2) Then press (Remote Control 2) [Stop], one short beep sound occurs, indicating that the setting is completed.

Clear Off Password:

- (1) Press [OPEN] + [STOP] + [CLOSE] + [LEFT LIGHT FILTERING] or [RIGHT LIGHT FILTERING] altogether 4 keys. Beep sounds will occur immediately.
- (2) Then, within 5 seconds, press [OPEN] + [CLOSE], the beep sounds will stop, indicating that the setting is completed.

5-4 Instructions for using Remote Control Holder

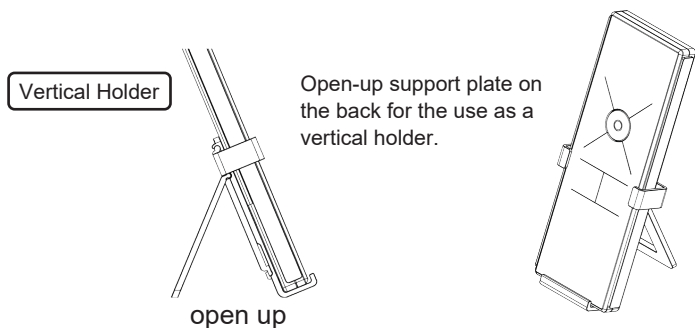

Wall-mount Holder

Apply the provided double-face adhesive tape on the back of Holder and stick it onto the desired position on the wall, as a wall-mounted holder.

Apply the adhesive tape

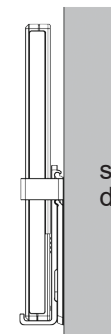
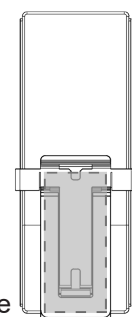

stick it onto the desired position